

**"U.S. PUBLIC LAND SURVEY MONUMENT RECORD"
OZAUKEE COUNTY, WISCONSIN**

CORNER INDEX No. 508-1
SECTION 31
TOWNSHIP 11
RANGE 21

TYPE OF MONUMENT: 3/4"x 12' solid aluminum rod with aluminum cap
STATE PLANE COORDINATES: N: 509469.92
E: 2526353.25
ELEVATION: 866.88 M.S.L. DATUM: 1929
THETA ANGLE: _____
FIELD BOOK: 3 PAGE: 29
FIELDWORK BY: TOM GENSKE 1996, KAPUR AND ASSOCIATES 1998
RECORD DRAWN BY: MARK BANTON
CONTROL ACCURACY:
HORIZONTAL: 3RD ORDER, CLASS 1 VERTICAL: 3RD ORDER

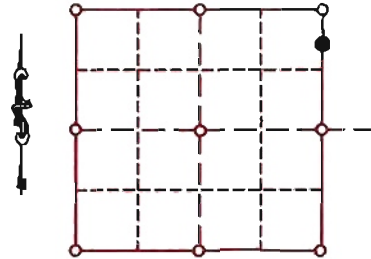

LOCATION

BASIS OF MONUMENT LOCATION

1996 - TOM GENSKE, OZAUKEE COUNTY SURVEYOR SET 3/4"x 12' ALUMINUM ROD WITH CAP EAST OF EAST 1/4 CORNER USING GPS
1998 - KAPUR AND ASSOCIATES ESTABLISHED CO-ORDINATES AS PART OF OZAUKEE COUNTY REMONUMENTATION PROGRAM

SEAL:



DATA SHOWN HEREON IS CERTIFIED AS CORRECT:

Mark Banton
Ozaukee County Surveyor

DATE: 12/8/08

TIE SKETCH

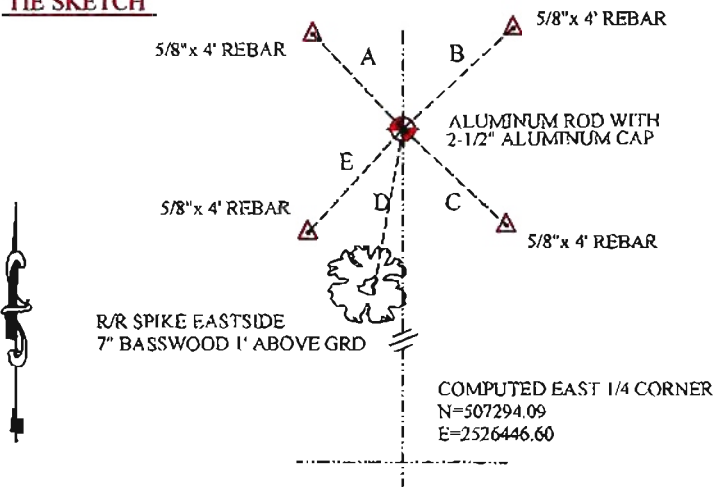

A = 37.40'@326°13'
B = 27.85'@43°35'
C = 35.47'@145°52'
D = 51.52'@182°52'
E = 39.69'@217°28'

MAINTENANCE RECORD

- MONUMENT LEGEND**
 = BERNTSEN MONUMENT (SEE TYPE OF MON. ABOVE)
 = CONCRETE MONUMENT w/ BRASS CAP
 = CONCRETE MONUMENT w/ CROSS
 = 5/8" REBAR WITH ALUMINUM CAP

DATE	BY WHOM	REMARKS
DEC 2008	M. BANTON	Redraw from tie sheet and re-number corner