

# "U.S. PUBLIC LAND SURVEY MONUMENT RECORD" OZAUKEE COUNTY, WISCONSIN

TYPE OF MONUMENT: Berntsen aluminum monument w/ 2" risor

STATE PLANE COORDINATES: N: 502575.82

E: 2548872.86

ELEVATION: 749.89 M.S.L. DATUM: 1929

FIELD BOOK: 2 PAGE: 32

FIELDWORK BY: Tom Genske & KAPUR & ASSOC 1994

RECORD DRAWN BY: MARK BANTON

CONTROL ACCURACY:

HORIZONTAL: 3RD ORDER CLASS 1 VERTICAL: 3RD ORDER

CORNER INDEX No. 460

SECTION 6

TOWNSHIP 10

RANGE 22

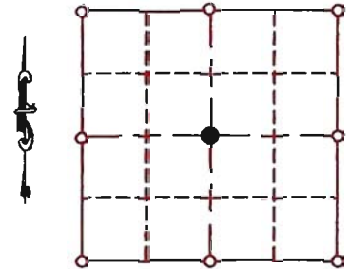

LOCATION

### BASIS OF MONUMENT LOCATION

1995- Tom Genske (County Surveyor) replaced a SEWRPAC concrete monument with damaged top, used center and set new monument

SEAL:



DATA SHOWN HEREON  
IS CERTIFIED AS CORRECT:

*Mark Banton*  
Ozaukee County Surveyor

DATE: 1-17-08

### TIE SKETCH

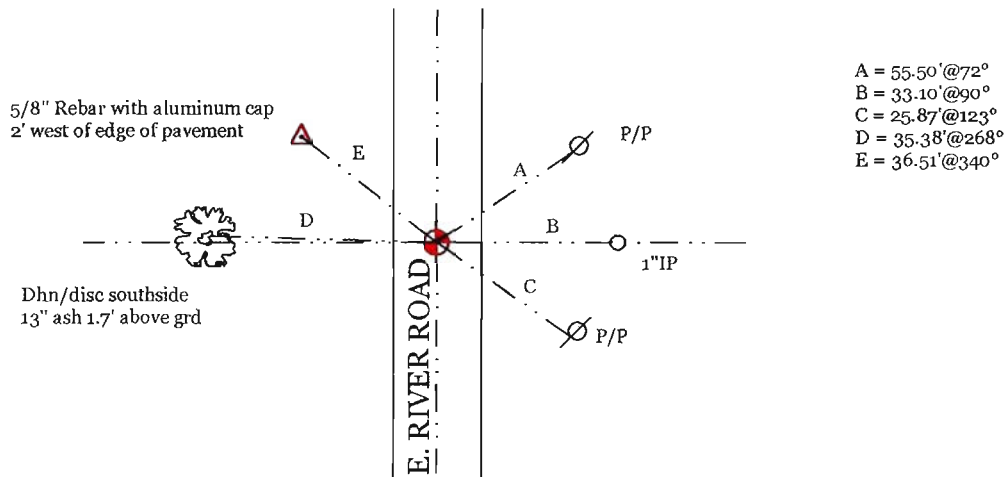

### MAINTENANCE RECORD

#### MONUMENT LEGEND

- = BERNTSEN MONUMENT ( SEE TYPE OF MON. ABOVE)
- = CONCRETE MONUMENT w/ BRASS CAP
- = CONCRETE MONUMENT w/ CROSS
- = 5/8" REBAR WITH ALUMINUM CAP

DATE	BY WHOM	REMARKS
1/17/08	Mark Banton	draw from T. Genske fieldnotes