

"U.S. PUBLIC LAND SURVEY MONUMENT RECORD"
OZAUKEE COUNTY, WISCONSIN

CORNER INDEX No. 310-4
 SECTION 28
 TOWNSHIP 10
 RANGE 22

TYPE OF MONUMENT: CONCRETE MONUMENT WITH BRASS CAP
 STATE PLANE COORDINATES: N: 481772.09
 E: 2560917.67
 ELEVATION: 707.60 M.S.L. DATUM: 1929

FIELD BOOK: 3 PAGE: 10
 FIELDWORK BY: Tom Genske & kapur and Associates
 RECORD DRAWN BY: MARK BANTON from Tom Genske fieldnotes
 CONTROL ACCURACY:
 HORIZONTAL: 3RD ORDER, CLASS 1 VERTICAL: 3RD ORDER

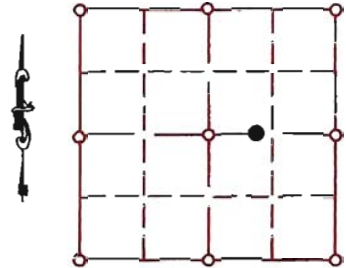

LOCATION

BASIS OF MONUMENT LOCATION

1995 - Tom Genske (County Surveyor) replaced rebar with concrete monument with brass cap

SEAL:



DATA SHOWN HEREON
 IS CERTIFIED AS CORRECT:

Mark Banton
 Ozaukee County Surveyor

DATE: 22 Jan 08

TIE SKETCH

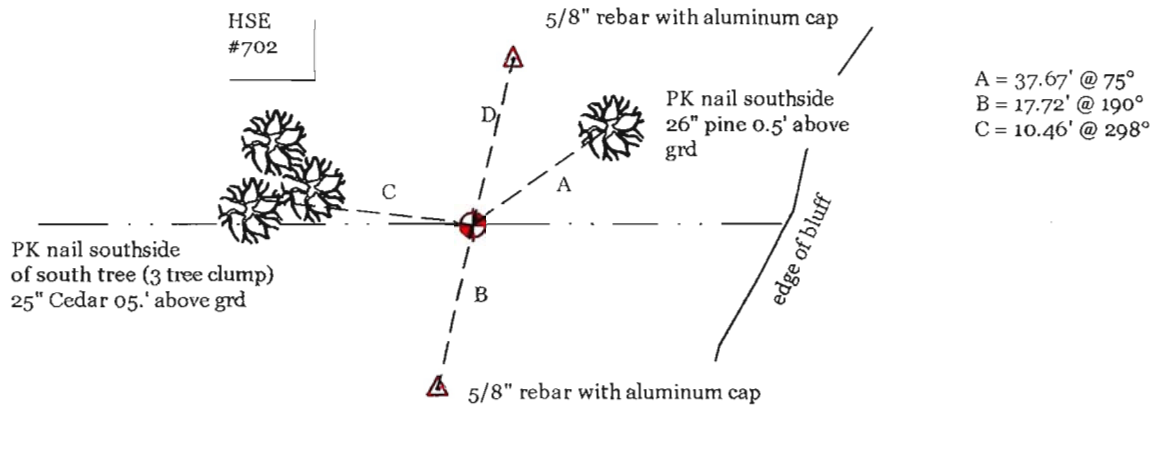

MAINTENANCE RECORD

- MONUMENT LEGEND**
- = BERNTSEN MONUMENT (SEE TYPE OF MON. ABOVE)
 - = CONCRETE MONUMENT w/ BRASS CAP
 - = CONCRETE MONUMENT w/ CROSS
 - = 5/8" REBAR WITH ALUMINUM CAP

DATE	BY WHOM	REMARKS
22 Jan 2008	M. Banton	re-draw and re-number corner