

RECORD OF U.S. PUBLIC LAND SURVEY CONTROL STATION

U.S. PUBLIC LAND SURVEY CORNER $\frac{3}{2}$ T 10 N, R 21 E, OZAUKEE COUNTY, WIS.

GEODETIC SURVEY BY: AERO-METRIC ENGINEERING, INC. YEAR: 1986

STATE PLANE COORDINATES OF:	SECTION CORNER	
NORTH	499,171.09	*499,171.41
EAST	2,535,843.18	*2,535,842.84

ELEVATION OF STATION: -841.65

HORIZONTAL DATUM: WISCONSIN STATE PLANE COORDINATE SYSTEM, SOUTH ZONE

VERTICAL DATUM: NATIONAL GEODETIC VERTICAL DATUM OF 1929

CONTROL ACCURACY: *Kapur & Associates Inc. 1995 THETA ANGLE: +01-23-04

HORIZONTAL: THIRD ORDER CLASS I VERTICAL: SECOND ORDER CLASS II

LOCATION SKETCH:

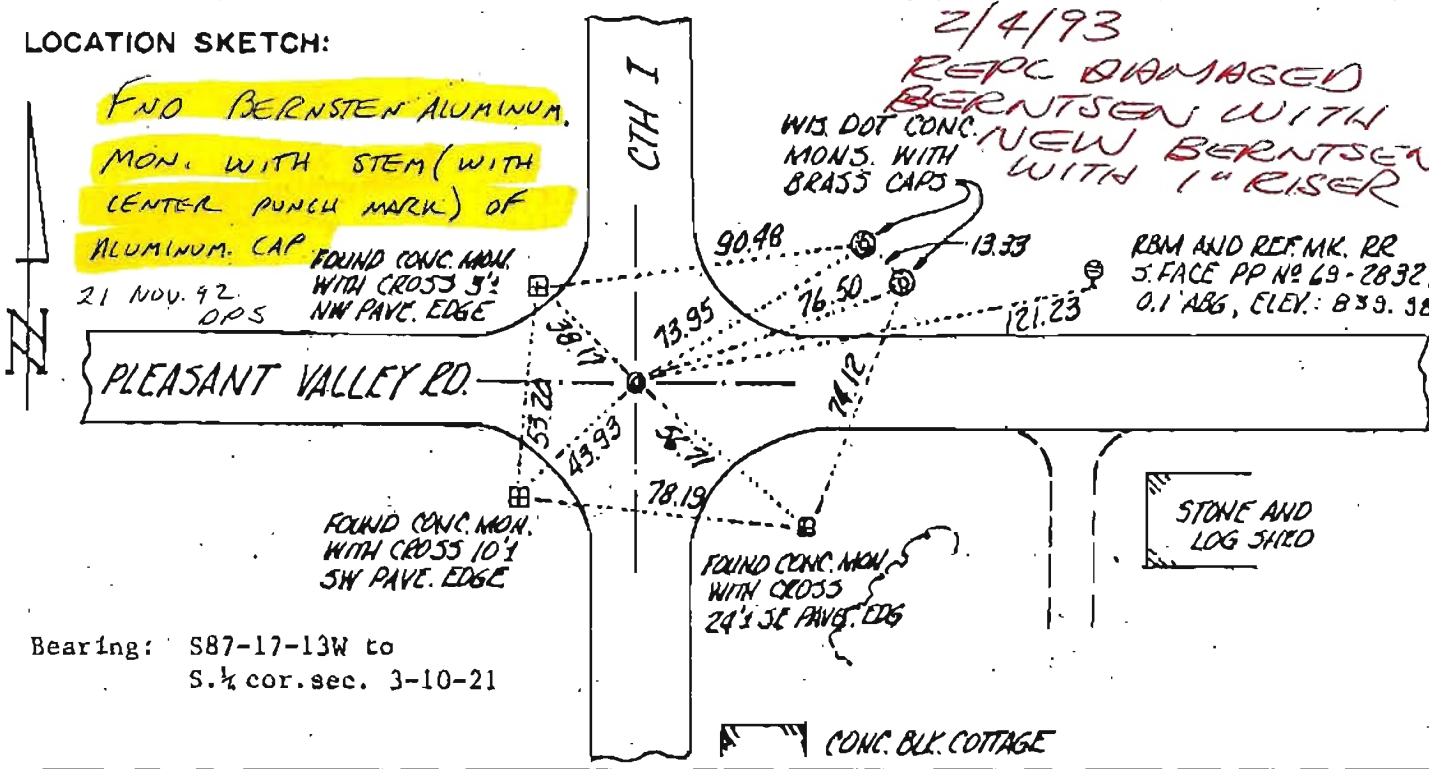

SURVEYOR'S AFFIDAVIT:

STATE OF WISCONSIN) SS
WAUKESHA COUNTY)

I HEREBY CERTIFY THAT I found a Berntsen monument with aluminum cap as set by Thomas J. Genske, S-1317, to mark this corner in September 1980; replacing an old cut limestone monument about 2.5 feet below the surface then marking this corner; and that I referenced the same as shown hereon.

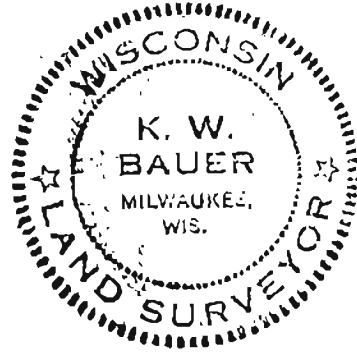

DATE OF SURVEY: 22 May 1986

Kurt W. Bauer
REGISTERED LAND SURVEYOR

S - 157