

"U.S. PUBLIC LAND SURVEY MONUMENT RECORD" OZAUKEE COUNTY, WISCONSIN

TYPE OF MONUMENT: Bernsten Monument w/ brass cap

STATE PLANE COORDINATES: N: 564788.44

E: 2584585.28

ELEVATION: 590.64 M.S.L. DATUM: 1929

FIELD BOOK: K&A folder PAGE: 814

FIELDWORK BY: KAPUR AND ASSOCIATES - 1999

RECORD DRAWN BY: MARK BANTON

CONTROL ACCURACY:

HORIZONTAL: 3RD ORDER, CLASS 1 VERTICAL: 3RD ORDER

CORNER INDEX No. 1012-4
SECTION 6
TOWNSHIP 12
RANGE 23

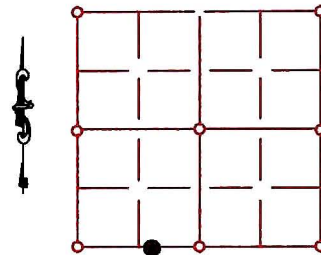

LOCATION

SEAL:

BASIS OF MONUMENT LOCATION

Found PK nail called for in previous survey, also found 1/2" iron rod to east. NE 1/4 of 12, PK nail and iron rod all on line. Set new monument at PK nail



DATA SHOWN HEREON IS CERTIFIED AS CORRECT:

Mark Banton 1 FEB 07
Ozaukee County Surveyor

DATE: 11-01-2004

TIE SKETCH

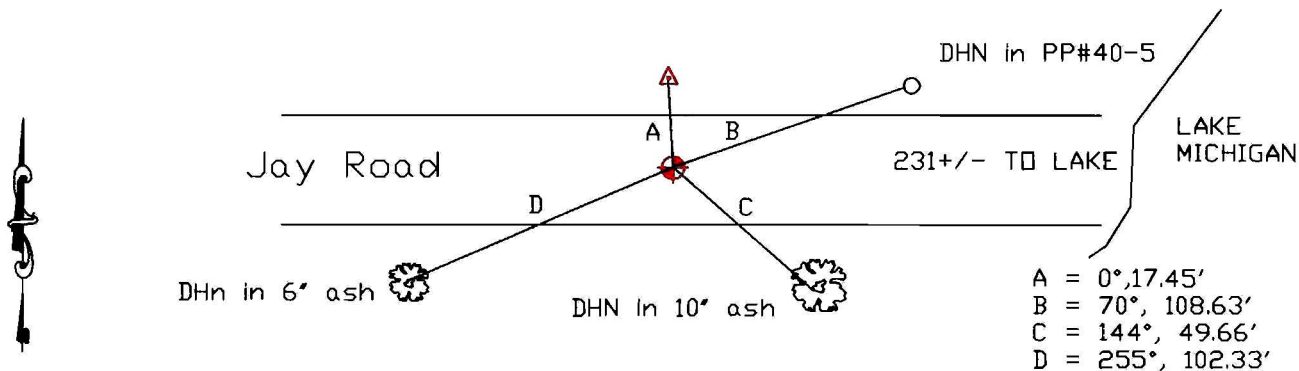

MAINTENANCE RECORD

- MONUMENT LEGEND
- = BERNTSEN MONUMENT (SEE TYPE OF MON. ABOVE)
 - = CONCRETE MONUMENT w/ BRASS CAP
 - = CONCRETE MONUMENT w/ CROSS
 - = 5/8" REBAR WITH ALUMINUM CAP

DATE	BY WHOM	REMARKS
1 FEB 07	M. BANTON	RE-NUMBER CORNER