

"U.S. PUBLIC LAND SURVEY MONUMENT RECORD"
OZAUKEE COUNTY, WISCONSIN

TYPE OF MONUMENT: Berntsen plastic monument w/ brass cap

STATE PLANE COORDINATES: N: 569521.69

E: 2556523.62

ELEVATION: 803.03 M.S.L. DATUM: 1929

FIELD BOOK: K&A Folder PAGE: 855

FIELDWORK BY: Kapur and Associates 1999

RECORD DRAWN BY: MARK BANTON

CONTROL ACCURACY:

HORIZONTAL: 3RD ORDER CLASS 1 VERTICAL: 3RD ORDER

CORNER INDEX No. 1084

SECTION 5

TOWNSHIP 12

RANGE 22

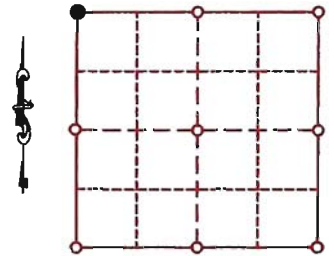

LOCATION

BASIS OF MONUMENT LOCATION

1999 - KAPUR 7 ASSOCIATES MOVED CORNER 0.08' NORTH TO SHEBOYGAN CTY LINE A BERNSTEN MONUMENT WITH BRASS CAP. TIES WERE SET

2007 - MARK BANTON S-1691 REDRAW DOSSIER TO SHOW CO-ORDINATES AND ELEVATION FROM OZAUKEE COUNTY REMONUMENTATION PROGRAM

SEAL:



DATA SHOWN HEREON IS CERTIFIED AS CORRECT:

Mark Banton
 Ozaukee County Surveyor

DATE: 15 FEBRUARY 2007

TIE SKETCH

- A = 25.39'
- B = 77.38'
- C = 62.42'
- D = 47.66'
- E = 45.51'

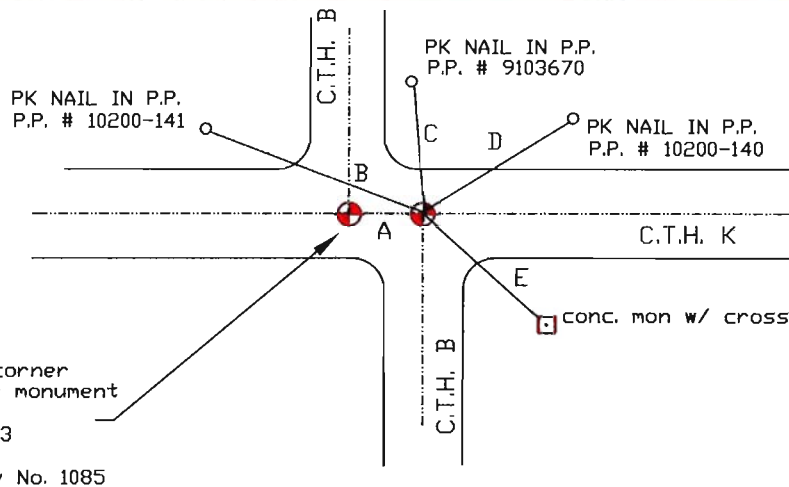

MAINTENANCE RECORD

- MONUMENT LEGEND**
- = BERNTSEN MONUMENT (SEE TYPE OF MON. ABOVE)
 - = CONCRETE MONUMENT w/ BRASS CAP
 - = CONCRETE MONUMENT w/ CROSS
 - = 5/8" REBAR WITH ALUMINUM CAP

DATE	BY WHOM	REMARKS