

COUNTY OSHAUKEE
 TOWN BELGIUM
 R.O.A. C.T.H. "B"
 SECTION NO 8
 TOWN 12 NORTH, RANGE 22 EAST
 TYPE OF LANDMARK _____
 LOCATION INDICATED ON SKETCH Y

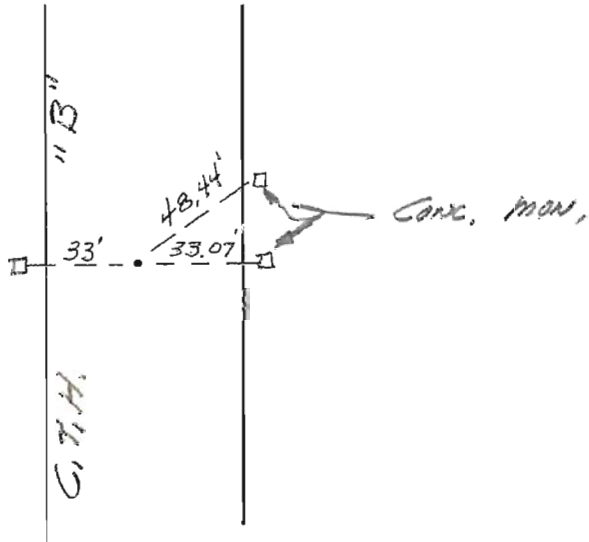
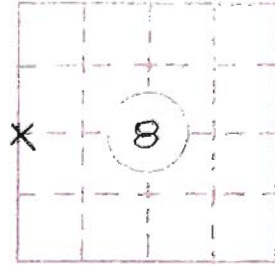

SURVEYOR'S AFFIDAVIT

STATE OF WISCONSIN, SS
 OSHAUKEE COUNTY

I HEREBY CERTIFY THAT FOUND OLD
LIMESTONE APPROX 14" DEEP IN
GOOD CONDITION. SET CONCRETE
MONUMENTS FROM THE STONE

DATE OF SURVEY 1973

Mary Debra Lee
 REGISTERED LAND SURVEYOR

294