

PRESERVATION OF LANDMARKS

COUNTY OZAUKEE

TOWN BELGIUM

ROAD G.T.H. "B" + G.T.H. "D"

SECTION NO. 17

TOWN 12 NORTH, RANGE 22 EAST

TYPE OF LANDMARK BRASS PLUG

LOCATION INDICATED ON SKETCH X

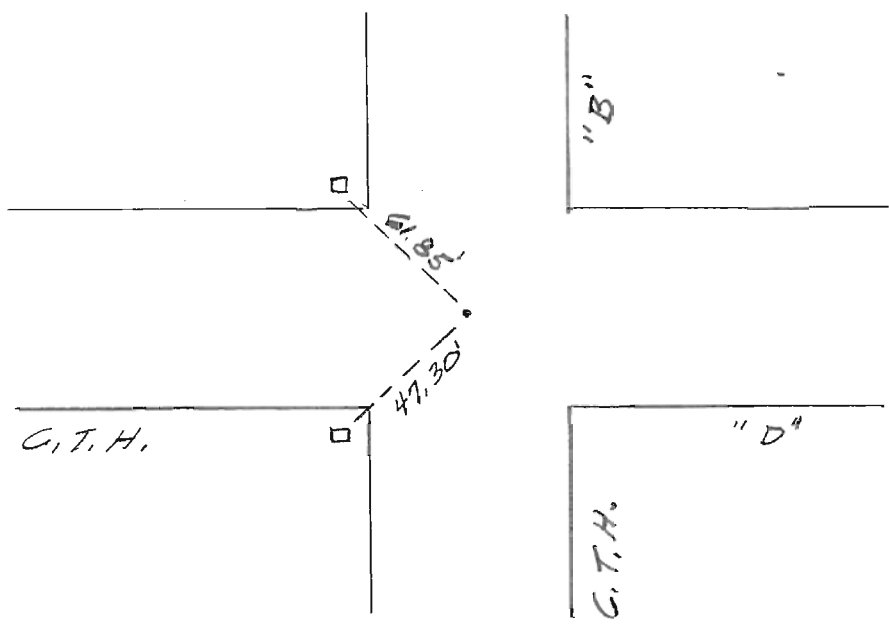
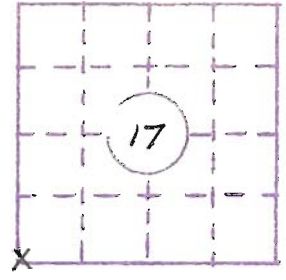

SURVEYOR'S AFFIDAVIT:

STATE OF WISCONSIN)
OZAUKEE COUNTY) SS

I HEREBY CERTIFY THAT PLACED IRON
DISC WITH CROSS OVER EXIST.
DISC.

DATE OF SURVEY 1973

Nancy Beckwith
REGISTERED LAND SURVEYOR

S- 294