

**"U.S. PUBLIC LAND SURVEY MONUMENT RECORD"  
OZAUKEE COUNTY, WISCONSIN**

**TYPE OF MONUMENT:** bernsten monument w/ brass cap

**STATE PLANE COORDINATES:** N: 543617.61

E: 2583000.65

**ELEVATION:** 593.60 **M.S.L. DATUM:** 1929

**FIELD BOOK:** Belgium **PAGE:** 605

**FIELDWORK BY:** Kapur and Associates

**RECORD DRAWN BY:** MARK BANTON

**CONTROL ACCURACY:**

**HORIZONTAL:** 3RD ORDER, CLASS 1 **VERTICAL:** 3RD ORDER

**CORNER INDEX No.** 806-4

**SECTION** 36

**TOWNSHIP** 12

**RANGE** 22

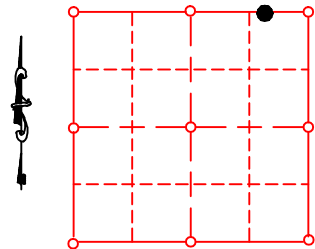

**LOCATION**

**BASIS OF MONUMENT LOCATION**

KAPUR AND ASSOCIATES 1999 - SET BERNSTEN MONUMENT @ PK NAIL  
MARK BANTON -2005 REDRAW DOSSIER TO SHOW CO-ORDINATES AND ELEVATION

**SEAL:**



**DATA SHOWN HEREON  
IS CERTIFIED AS CORRECT:**

*Mark Banton*

Ozaukee County Surveyor

**DATE:** 2-1-08

**TIE SKETCH**

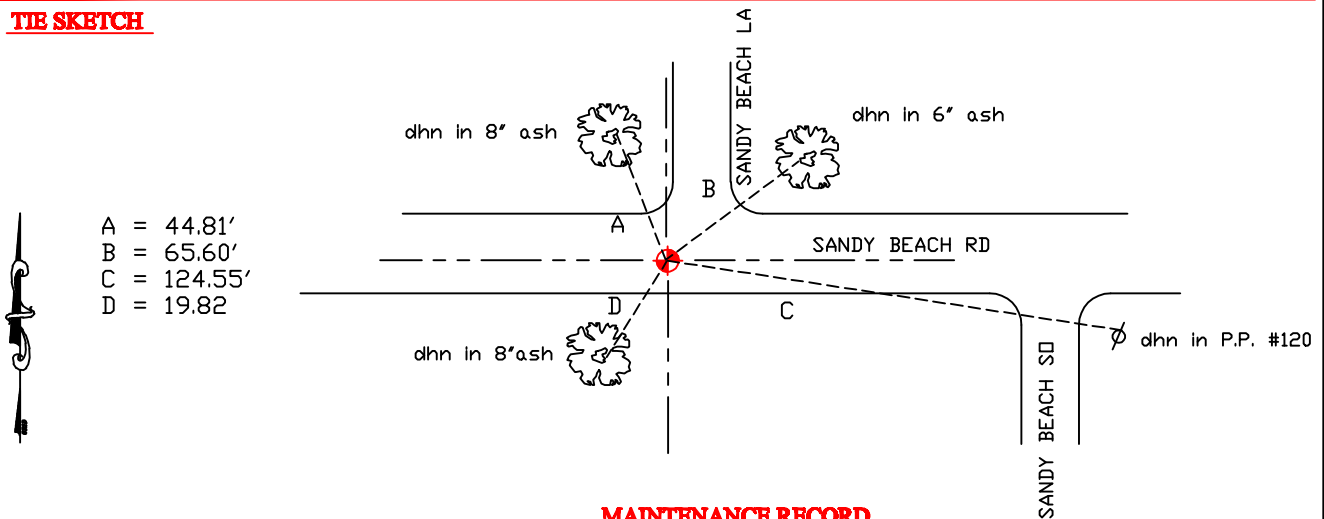

**MAINTENANCE RECORD**

- MONUMENT LEGEND**
- = BERNSTEN MONUMENT (SEE TYPE OF MON. ABOVE)
  - = CONCRETE MONUMENT w/ BRASS CAP
  - = CONCRETE MONUMENT w/ CROSS
  - = 5/8" REBAR WITH ALUMINUM CAP

DATE	BY WHOM	REMARKS
1 feb 08	m. banton	re-number corner